



Art.nr:
625035

Aqua Di Mare

Aqua Di Mare is a mixture of minerals for use in spas and swimming pools. Aqua Di Mare can be compared to the thermal tradition of the ancient Romans or the therapeutic properties of the Dead Sea, which have a positive effect on the skin.

Usage instruction:

use one litre of Aqua Di Mare for 1000 litres of spa water.

Keep out of the reach of children.



Instructions for Aqua Excellent with NEW spa.

Ensure your (new or used) spa to always be clean. In order to do so, use Aqua Excellent Spacleaner.

Procedure with NEW spa: to prevent test water from a new spa contaminating the water, clean the spa before use as detailed below:

- Fill the spa with tap water.
- Add 0.5 liter of Aqua Excellent Spacleaner to the spa's water.
- Make sure all jet nozzles are open and switch the pumps on at the highest level for 15 minutes.
- Leave the water in the spa overnight.
- Repeat step c.
- Let the water drain and flush with clean tap water. Let this last water drain as well.
- Fill the spa with clean tap water and re-install the cleaned or a new filter.
- Make sure the pH value always ranges between 7.2 and 7.4.
- Apply the chlorine dosage unit with the chlorine tab on the filter unit and heat your spa to the temperature requested (38 °C).
- Start treating the water with Aqua Excellent All-in-One as specified in the respective instructions.
- The night before refilling is scheduled (each 3 months), start the procedure with step a.

Tip: check you spa water's pH value every 3 weeks.



Instructions for Aqua Excellent with USED spas.

Ensure your (new or used) spa to always be clean. In order to do so, use Aqua Excellent Spacleaner.

Procedure with USED spas:

- Add 0.5 liter of Aqua Excellent Spacleaner to the spa's water the night before you plan to refill it.
- Make sure all jet nozzles are open and switch the pumps on at the highest level for 15 minutes.
- Leave the water in the spa overnight.
- Repeat step b.
- Let the water drain and flush with clean tap water. Let this last water drain as well.
- Remove the filter and clean it with Aqua Excellent Filtercleaner*.
- Fill the spa with clean tap water and re-install the cleaned or a new filter.
- Make sure the pH value always ranges between 7.2 and 7.4.
- Apply the chlorine dosage unit with the chlorine tab on the filter unit and heat your spa to the temperature requested (38 °C).
- Start treating the water with Aqua Excellent All-in-One as specified in the respective instructions.
- The night before refilling is scheduled (each 3 months), start the procedure with step a.

Tip: check you spa water's pH value every 3 weeks.

* Instructions for the Filtercleaner:

- Sprinkle 2 scoops of Aqua Excellent Filtercleaner over the filter.
- Place the filter into a bucket.
- Fill the bucket with hot water.
- Leave the filter in there for 1 to 1.5 hours to soak (turn filter around every once in a while).
- Rinse the filter with a water jet and re-install it with the spa.



AQUA Excellent



Aqua Excellent bath perfume treats body and soul.

It consists of carefully chosen herbs and perfume oils and is suitable for aromatherapy treatment.

Ingredients: varies by packaging, 12 different types.

Application:

For a bath, dissolve 10 ml of bath perfume in water at a temperature of 36° - 38°C. Suffices for 20 applications.

Not to be used in combination with soaps or shampoos. ESPECIALLY for use in Spa's

www.aqua-excellent.com • info@aqua-excellent.com

www.aqua-excellent.com • info@aqua-excellent.com

www.aqua-excellent.com • info@aqua-excellent.com

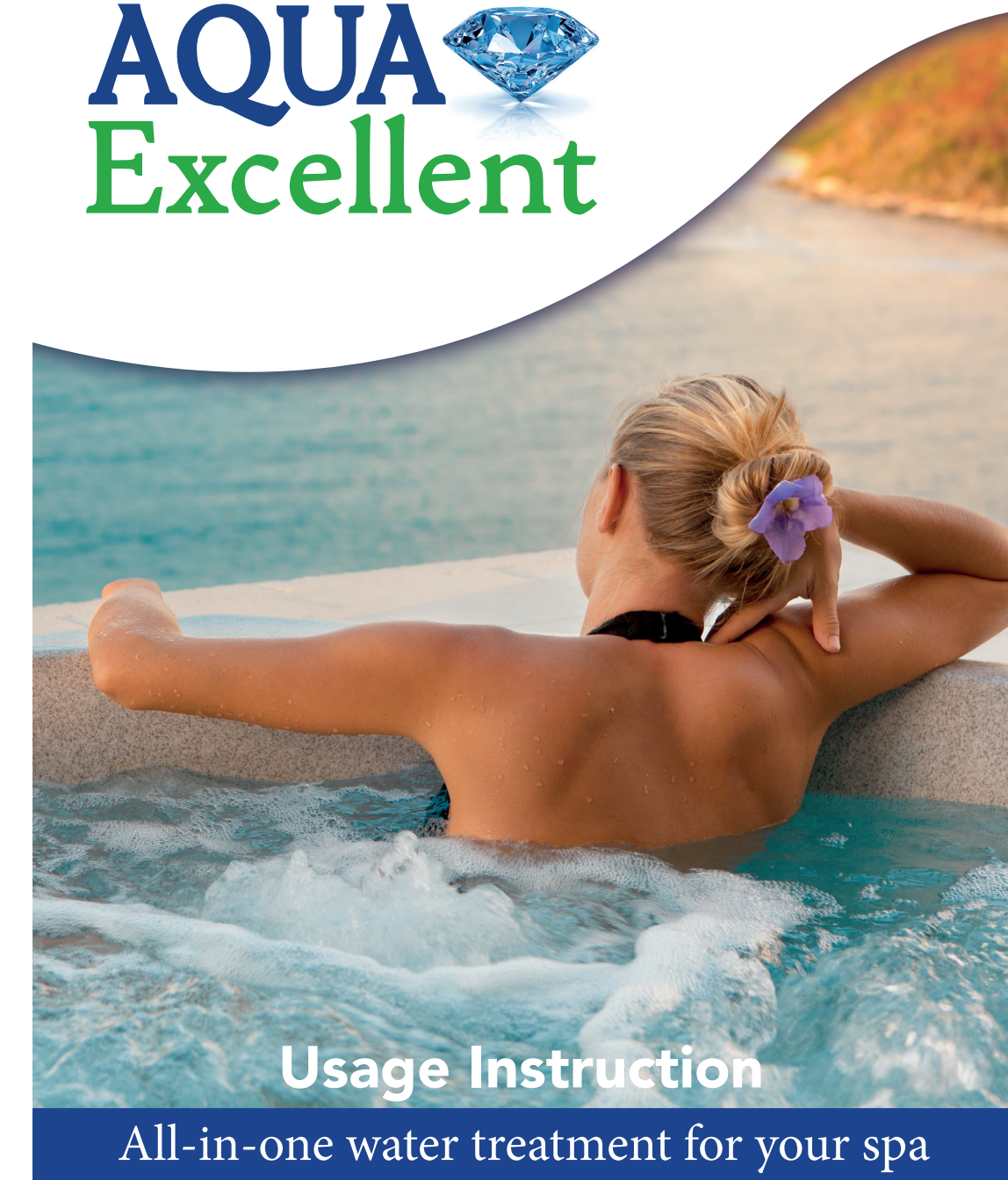

AS CLEAN AS WATER CAN BE

1

Spa de conteúdo (litros)	Aplicar semanalmente (ml)
700 - 800	80 ml
900 - 1000	90 ml
1001 - 1200	100 ml
1201 - 1400	125 ml
1401 - 1600	150 ml
1601 - 1800	175 ml
1801 - 2000	200 ml
2001 - 2200	225 ml

Soft and Easy

Aqua Excellent Spa Water Treatment Contents of the Big Pack:

- 2 bottles of 1 liter of Aqua Excellent
- 18 chlorine tablets 90/20
- 1 dispenser (for chlorine tablets 90/20)
- 1 measuring cup of 200 ml
- 1 cloth Microfiber Cleaning Cloth
- 1 Usage instruction

Usage instruction:

1. Shake Aqua Excellent bottle before use.
2. Add Aqua Excellent to the water in your jacuzzi using the measuring cup (according to the quantities indicated in the table). (See page 2, Fig. 1).
3. Turn on all Spa massage pumps for 2 minutes.
4. Insert a 90/20 chlorine tablet into the dispenser and place the dispenser into the filter element. Make sure that the dispenser is normally below the water level (see page 2, fig. 2) and that it contains the 90/20 chlorine tablet.

Repeat the above procedure on a weekly basis.

Important note!

Keep out of reach of children. Avoid eye contact. In case of contact of Aqua Excellent with the eyes, rinse immediately and abundantly with clear water and consult a doctor. If Aqua Excellent is swallowed, seek medical advice immediately and show the product packaging or this leaflet to the physician.

For more information, please contact your distribution partner, or send an e-mail to info@aqua-excellent.com or visit us at www.aqua-excellent.com

www.aqua-excellent.com • info@aqua-excellent.com

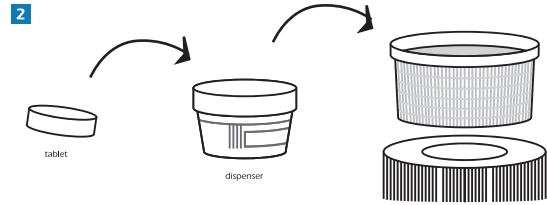

Art.nr: 172640

Aqua Excellent swim spa:

Contents:

- 26 Aqua Excellent sachets (100 gr)
- 1 chlorine tablet dispenser
- 90/20 chlorine tablets (30 pieces)
- 1 microfiber cleaning cloth
- 1 Usage instruction

Usage instruction:

1. Dissolve Aqua Excellent (according to the days indicated in the table) one sachet in lukewarm water and add the solution to your spa water
2. Place a 90/20 chlorine tablet in the dispenser and place the dispenser on the filter element. Make sure the dispenser is generally below water level and contains a 90/20 chlorine tablet
3. Repeat the above procedure weekly.

Important note!

Keep out of reach of children. Avoid eye contact. In case of contact of Aqua Excellent with the eyes, rinse immediately and abundantly with clear water and consult a doctor. If Aqua Excellent is swallowed, seek medical advice immediately and show the product packaging or this leaflet to the physician.

For more information, please contact your distribution partner, or send an e-mail to info@aqua-excellent.com or visit us at www.aqua-excellent.com



Art.nr:
172794

Filter Cleaner Spray

Special product for cleaning cartridge filters, for direct use. Removes oil, grease and limescale deposits.

Usage instructions:

Spray cartridge and soak for 3-6 minutes. Rinse the filter well with clear water.

Keep out of reach of children

www.aqua-excellent.com • info@aqua-excellent.com



Art.nr:
123947



Art.nr:
123916

Filter Cleaner

For crystal clear water, clean your spa filter once a week with Aqua Excellent Filter Cleaner.

Usage instructions:

1. Remove the filter from your spa.
2. Place two tablespoons of filter cleaner into the filter.
3. Place the filter in a bucket or filter cleaning tube.
4. Fill the bucket with 10 liters of hot water.
5. Leave the filter inside for 1-1.5 hour(s). (Turn the filter from time to time).
6. Rinse the filter under running water and reinstall it in the spa.

Keep out of reach of children.



Art.nr:
123961

Spa Cleaner

The spa cleaner is specially designed to clean the air chambers and your entire spa. Cleans water pipes of limescale and contaminating residues. Use spa cleaners every time you change the water. We recommend a quarterly replacement of your pool water.

1. Add 250ml of Spa Cleanser to the water 24 hours before you want to change it.
2. Make sure all air jets and valves are open. Then turn on the pumps for a maximum of 15 minutes. Repeat three times.
3. Remove the filter before letting the water run out.
4. Clean the filter with Aqua Excellent filter cleaner.
5. Wash your spa with fresh water.
6. Fill your spa with fresh municipal water and reinsert the clean filter.

Keep cleaning your spa pool with Aqua Excellent Water Care.

Keep out of reach of children.

www.aqua-excellent.com • info@aqua-excellent.com



Art.nr:
172015

Cover Cleaner

To clean and protect the spa cover. Gives shine to all vinyl surfaces. Provides a restorative and protective coating to prevent fading.

Usage instructions:

1. Shake before use.
2. Use the product undiluted with a sponge or dry cloth.
3. Apply in circular movements on a dry surface.
4. Let dry 15-20 minutes before rubbing with a dry cloth (polish wise).
5. Repeat every three months.

Keep out of reach of children.



Art.nr:
172039

Shell Polish

For cleaning and polishing whirlpool tubs. Protects your spa from chemicals. Prevents oxidation and deposits. Also used for maintenance of acrylic baths.

Usage instruction:

1. Shake before use.
2. Use the product undiluted with a sponge or dry cloth.
3. Apply in circular movements on a dry surface.
4. Allow to dry for 15-20 minutes before wiping with a dry cloth.

www.aqua-excellent.com • info@aqua-excellent.com

